

# Public notice

## Consort Road and Nazareth Gardens improvements

*The London Borough of Southwark (Prescribed routes) (Consort Road and Nazareth Gardens) Traffic Order 202\**  
*The London Borough of Southwark (Waiting restrictions) (Consort Road and Nazareth Gardens) Order 202\**

1. Southwark Council hereby GIVES NOTICE that it proposes to make the above Orders under sections 6 and 124 of and Part IV of Schedule 9 to the Road Traffic Regulation Act 1984, as amended.
2. The effects of the Orders would be to accommodate 'one-way' eastbound operation throughout the private road which lies between the north-eastern kerb-line of Consort Road and the south-western kerb-line of Nazareth Gardens (fronting Nos. 33 to 42 Nazareth Gardens and henceforth referred to as 'the private road'):-
  - (a) to prohibit access for any vehicle by way of 'no entry' signs (i) from NAZARETH GARDENS into 'the private road' and (ii) from 'the private road' into CONSORT ROAD;
  - (b) to prohibit any vehicle proceeding in a northwest-bound direction in CONSORT ROAD from turning right upon reaching its junction with 'the private road';
  - (c) to reduce existing 'at any time' waiting restrictions by 21.5 metres in CONSORT ROAD on the north-east side across its junction with 'the private road'; and
  - (d) to convert 16 metres of existing timed waiting restrictions (single yellow lines) to new 'at any time' waiting restrictions in NAZARETH GARDENS on the south-west side across its junction with 'the private road'.

*NOTES: (1) Exemption to the restrictions described in (a) and (b) preceding, would be provided for emergency services vehicles and refuse collection vehicles. (2) All measurements are in metres 'm' and are approximate. Parking charges are listed on [www.southwark.gov.uk/parking](http://www.southwark.gov.uk/parking).*

3. For more information contact Sunny Costin of the Council's Highway Development team - [highways@southwark.gov.uk](mailto:highways@southwark.gov.uk).
4. Copies of this Notice, the proposed Orders, and a statement of the Council's reasons for making the Orders together with plans showing the location and effect of the Orders may be either: found online at [www.southwark.gov.uk/trafficorders](http://www.southwark.gov.uk/trafficorders), or inspected by appointment only at: Highways, Southwark Council, Environment and Leisure, 3rd floor hub 2, 160 Tooley Street, London SE1 2QH - from the date of this Notice until the end of a period of six weeks from the date on which the Orders are made. Contact [traffic.orders@southwark.gov.uk](mailto:traffic.orders@southwark.gov.uk) (or 020 7525 3497) for booking details.
5. Anyone wishing to object to or make any other representations regarding the proposals, may use the form labelled '*Parking - Road traffic and highway schemes - responding to statutory consultation notices*' at [www.southwark.gov.uk/statutoryconsultationnotices](http://www.southwark.gov.uk/statutoryconsultationnotices) or send a statement in writing to: the Traffic Orders Officer, Highways, Southwark Council, Environment and Leisure, P.O. Box 64529, London SE1P 5LX or by e-mail to [traffic.orders@southwark.gov.uk](mailto:traffic.orders@southwark.gov.uk) quoting reference '*TMO2122-023\_Consort Road*' by 25 November 2021. Please note that if you wish to object to this proposal you must state the grounds on which your objection is made.
6. Under requirements of current access to information legislation, any letter or e-mail sent to the Council in response to this Notice may be subject to publication or disclosure, or both, including communication to other persons affected.

Dated 4 November 2021

**Dale Foden** - Head of Service - Highways, Environment and Leisure

# Statement of reasons

## Consort Road and Nazareth Gardens improvements

*The London Borough of Southwark (Prescribed routes) (Consort Road and Nazareth Gardens) Traffic Order 202\**  
*The London Borough of Southwark (Waiting restrictions) (Consort Road and Nazareth Gardens) Order 202\**

This scheme proposes permanent prescribed routes and changes to waiting restrictions in Consort Road and Nazareth Gardens within the Nunhead & Queen's Road ward and Rye Lane ward, in the London Borough of Southwark.

Planning permission (ref: 19/AP/1203) has been granted for development of the area which include 'one-way' eastbound operation throughout the private road which lies between the north-eastern kerb-line of Consort Road and the south-western kerb-line of Nazareth Gardens (fronting Nos. 33 to 42 Nazareth Gardens and henceforth referred to as 'the private road').

To accommodate the 'one-way' working and clear access to 'the private road' there will be:

- (a) no access for any vehicle by way of 'no entry' signs (i) from Nazareth Gardens into 'the private road' and (ii) from 'the private road' into Consort Road;
- (b) no right turn for any vehicle proceeding in a northwest-bound direction in Consort Road at its junction with 'the private road'; and
- (c) changes to waiting restrictions across junctions with 'the private road' (i) on the north-east side of Consort Road existing 'at any time' waiting restrictions will be reduced by 21.5 metres, and (ii) on the south-west side of Nazareth Gardens 16 metres of existing timed waiting restrictions (single yellow lines) will be upgraded to new 'at any time' waiting restrictions (double yellow lines).

Dated 4 November 2021

For more information contact:

**Sunny Costin**  
Highway Development  
Highways

[Highways@southwark.gov.uk](mailto:Highways@southwark.gov.uk)

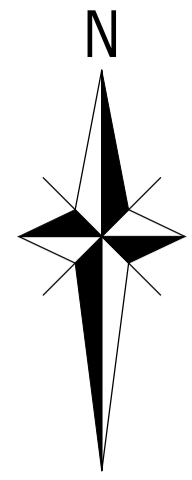

**VIEWPORT 2 - OVERVIEW PLAN**  
SCALE 1:200

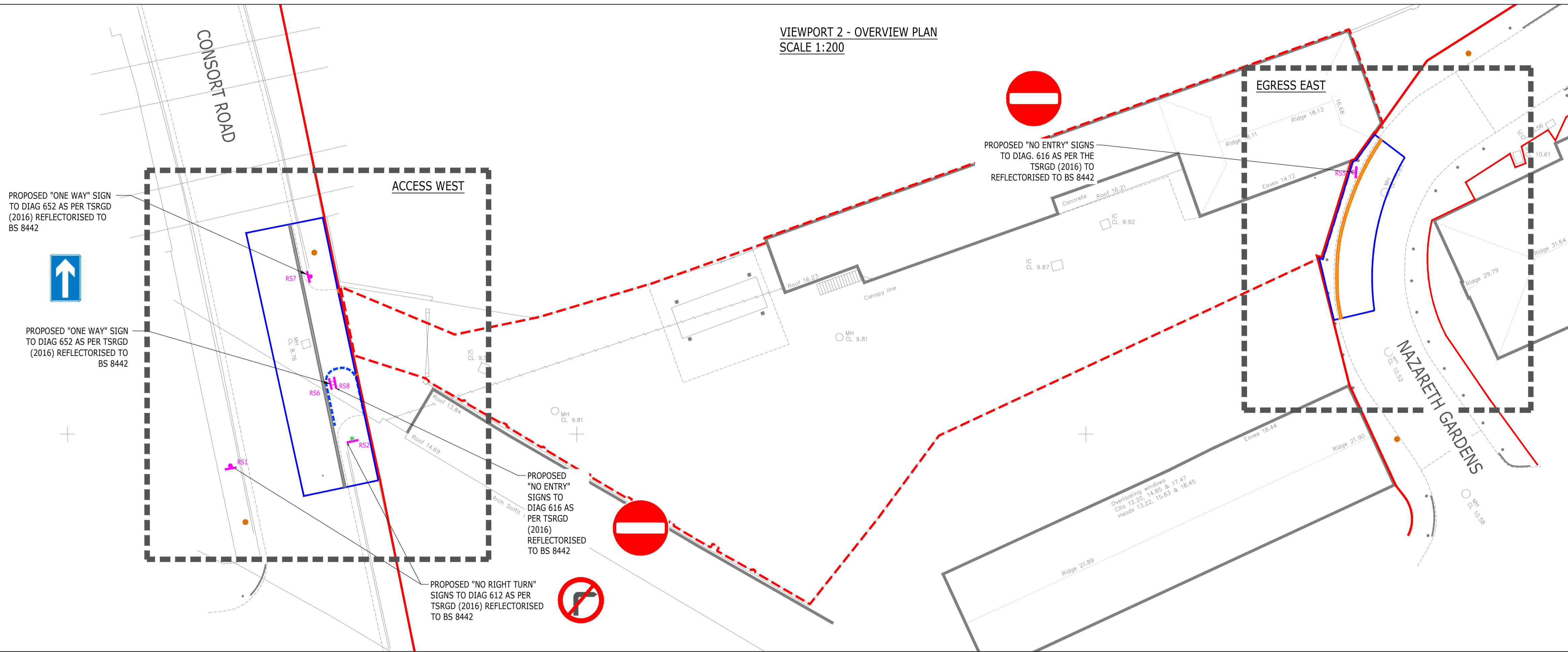

**TRAFFIC REGULATING ORDERS KEY:**

- EXISTING SITE BOUNDARY
- EXTENTS OF APPLICATION
- ASSUMED HIGHWAY BOUNDARY
- PROPOSED DOUBLE YELLOW LINES/ DOUBLE YELLOW LINES TO BE REINSTATED
- RS PROPOSED SIGNS SUBJECT TO A TRO

- NOTES:**
1. THIS DRAWING IS TO BE READ IN CONJUNCTION WITH THE RELEVANT SPECIFICATION AND ALL OTHER RELATED DRAWINGS ISSUED BY THE ENGINEER.
  2. DO NOT SCALE FROM THIS DRAWING. WORK FROM FIGURED DIMENSIONS ONLY.
  3. ALL DIMENSIONS SHOWN ON THIS DRAWING ARE IN MILLIMETRES UNLESS OTHERWISE STATED.
  4. ALL DIMENSIONS, LEVELS AND SURVEY GRID CO-ORDINATES ARE TO BE CHECKED ON SITE AND THE ENGINEER NOTIFIED IMMEDIATELY OF ANY DISCREPANCIES PRIOR TO THE COMMENCEMENT OF THE WORKS.
  5. NO DEVIATION FROM THE DETAILS SHOWN ON THIS DRAWING IS PERMITTED WITHOUT PRIOR PERMISSION FROM THE ENGINEER.
  6. ALL MATERIALS AND WORKMANSHIP SHALL COMPLY FULLY WITH THE MANUAL OF CONTRACT DOCUMENTS FOR HIGHWAY WORKS, VOLUME ONE SPECIFICATION FOR HIGHWAY WORKS AND THE LOCAL AUTHORITY LONDON BOROUGH OF SOUTHWARK SPECIFICATION FOR ROAD CONSTRUCTION AND STANDARD DETAILS.
  7. THE CONTRACTOR SHALL UNDERTAKE SUCH MATERIALS TESTING AS INDICATED IN THE SPECIFICATIONS AND SHALL INCLUDE THE COST OF TESTING IN THE TENDER.
  8. UNLESS STATED OTHERWISE, ALL EXCAVATED MATERIAL SHALL BE DISPOSED OF AT AN APPROVED TIP OFF-SITE.
  9. THE PUBLIC HIGHWAY AND WORKS WILL BE KEPT CLEAN AND FREE OF DEBRIS BY USE OF WHEEL WASHING FACILITIES AND ROAD SWEEPERS TO THE COUNCIL'S SATISFACTION.
  10. ALL SETTING OUT SHALL BE AGREED ON-SITE WITH THE ENGINEER, PRIOR TO THE COMMENCEMENT OF THE WORKS.
  11. TOPOGRAPHICAL SURVEY BY
  12. UPON COMPLETION OF THE WORKS, THE CONTRACTOR SHALL UNDERTAKE ALL NECESSARY MAINTENANCE REPAIRS TO RETURN THE HIGHWAY TO ITS FORMER CONDITION.
  13. THE CONTRACTOR SHALL BE RESPONSIBLE FOR OBTAINING ALL NECESSARY APPROVALS FROM THE LOCAL AUTHORITY PRIOR TO COMMENCING WORKS ON THE HIGHWAY.
  14. ALL WORKS TO COMPLY WITH THE SOUTHWARK STREETScape DESIGN MANUAL DATED AY 2020.
- CDM NOTES:**
1. THE ATTENTION OF THE CLIENT AND THE PRINCIPAL CONTRACTOR IS DRAWN TO THE FOLLOWING POTENTIAL RISKS IN CONJUNCTION WITH THE PROPOSED ON-SITE AND OFF-SITE WORKS AS DESIGNED FOR THIS PROJECT.
  2. WORKS IN THE VICINITY OF LIVE SERVICES INCLUDING GAS, ELECTRICITY AND BY WILL BE NECESSARY AND THE ADVICE OF ALL STATUTORY SERVICE COMPANIES MUST BE SOUGHT BEFORE ANY WORKS COMMENCE.
  3. WORKS WITHIN AND ADJUTING THE EXISTING HIGHWAY WILL ENTAIL TRAFFIC HAZARDS AND ALL APPROPRIATE SAFETY MEASURES INCLUDING BARRIERS, SIGNS AND LIGHTING MUST BE UNDERTAKEN TO THE APPROVAL OF THE LOCAL AUTHORITY, THE HIGHWAY AUTHORITY AND THE POLICE DEPARTMENT.
  4. HAZARDOUS MATERIALS INCLUDING CEMENT AND BITUMINOUS MATERIALS ARE SPECIFIED AND THE MANUFACTURERS ADVICE ON SAFE HANDLING PROCEDURES MUST BE OBTAINED AND MADE CLEAR TO ALL OPERATIVES. THE CONTRACTOR WILL BE RESPONSIBLE FOR LOCATING ALL EXISTING SERVICES WITHIN THE VICINITY OF THE WORKS HAND DUG AND ENSURE THESE ARE PROTECTED THROUGHOUT THE DURATION OF THE WORKS. ALL UTILITY PLANT SHOULD BE CLEARLY MARKED ON THE GROUND PRIOR TO COMMENCEMENT OF THE WORKS.
  5. THE CONTRACTOR MUST ENSURE ALL WORKING AREAS ARE FULLY SECURE. WORKS IN THE VICINITY OF NEARBY NETWORK RAIL INFRASTRUCTURE WILL ENTAIL HAZARDS AND ALL APPROPRIATE SAFETY MEASURES INCLUDING BARRIERS, SIGNS AND LIGHTING MUST BE UNDERTAKEN TO THE APPROVAL OF THE LOCAL AUTHORITY, NETWORK RAIL AND THE POLICE DEPARTMENT.

FOR INFORMATION ONLY

B	RS4 AND RS9 NO ENTRY SIGNS REMOVED	MAC	MAC	KM	19.07.21
A	AMENDED AS PER COMMENTS	MAC	MAC	KM	18.06.21
Rev	Description	Drn	Chk	App	Date

**ARDENT** CONSULTING ENGINEERS

Third Floor  
The Hallmark Building  
52-56 Leadenhall Street  
London  
EC3M 5JE

Tel: 020 7680 4088  
Web: www.ardent-ce.co.uk  
E-mail: enquiries@ardent-ce.co.uk

**worksafe consultant**  
www.smasid.com

**SSIP**  
SPECIALIST SOCIETY OF  
INTEGRATED PROJECT MANAGERS

Client: **PICFARE HOMES LIMITED**

Project Title: **39B CONSORT ROAD, PECKHAM**

Drawing Title: **TRAFFIC REGULATION ORDERS**

A1 Scale	Date	Designed by
AS SHOWN	apr 2021	MAC
Drawn by	Checked by	Approved by
MAC	MAC	AD
Drawing Number	Rev	Rev
191812-004	B	B

Ordnance Survey mapping amended to reflect on-site observations.  
Reproduced from/based upon Ordnance Survey material with the permission of the Controller of Her Majesty's Stationary Office. Crown Copyright Reserved. License No. 10002043



THE COUNCIL OF THE LONDON BOROUGH OF SOUTHWARK

# TRAFFIC MANAGEMENT ORDER

202\* No. \*\*\*

---

The London Borough of Southwark (Prescribed routes)  
(Consort Road and Nazareth Gardens) Traffic Order 202\*

Made: \*\* \*\*\*\*\* 202\*

Coming into force: \*\* \*\*\*\*\* 202\*

---

The Council of the London Borough of Southwark, after consulting the Commissioner of Police of the Metropolis, in exercise of the powers conferred by sections 6 and 124 of the Road Traffic Regulation Act 1984<sup>a</sup>, as amended, and of all other powers thereunto enabling, hereby make the following Order:

## Citation and commencement

- 1.1 This Order may be cited as the London Borough of Southwark (Prescribed routes) (Consort Road and Nazareth Gardens) Traffic Order 202\* and shall come into force on \*\* \*\*\*\*\* 202\*.

## Interpretation

- 2.1 In this Order:-

causing includes permitting;

“carriageway” has the same meaning as in section 329(1) of the Highways Act 1980<sup>b</sup>;

“Council” means the Council of the London Borough of Southwark;

“enactment” means any enactment, whether public general or local, and includes any order, bye-law, rule, regulation, scheme or other instrument having effect by virtue of an enactment;

“kerb-line” means the imaginary line which is the projection of the line formed by the edge of the carriageway of a street; and

“the private road” for the purposes of this Order, means the full carriageway (of which is private) which lies between the north-eastern kerb-line of Consort Road and the south-western kerb-line of Nazareth Gardens (fronting Nos. 33 to 42 Nazareth Gardens).

- 2.2 Any reference in this Order to any enactment shall be construed as a reference to that enactment as amended, applied, consolidated, re-enacted by or as having effect by virtue of any subsequent enactment.

---

<sup>a</sup> 1984 c.27

<sup>b</sup> 1980 c.66

Prescribed routes

- 3.1 No person causing any vehicle to proceed in a north-westbound direction in Consort Road, shall upon reaching its junction with “the private road”, cause that vehicle to turn right into “the private road”.
- 3.2 No person causing any vehicle to proceed in “the private road”, shall upon reaching its junction with Consort Road, cause that vehicle to enter into or proceed in Consort Road.
- 3.3 No person causing any vehicle to proceed in Nazareth Gardens, shall upon reaching its junction with “the private road”, cause that vehicle to enter into or proceed in “the private road”.

Exemptions

- 4.1 Nothing in Articles 3.1, 3.2 and 3.3 of this Order shall apply in relation to:-
  - (a) a vehicle being used for ambulance, fire brigade or police purposes; or
  - (b) anything done with the permission or at the direction of a police constable in uniform; or
  - (c) any person who causes any vehicle to proceed in accordance with any restriction or requirement indicated by traffic signs placed on the highway pursuant to section 66 or section 67 of the Road Traffic Regulation Act 1984.

Dated this xxxxxxxxxxxx day of xxxx 202\*

[signature here]

DALE FODEN

Head of Service, Highways  
Environment and Leisure

## EXPLANATORY NOTE

*(This note is not part of the Order)*

This Order, to accommodate 'one-way' eastbound operation throughout "the private road" (which lies between Consort Road and Nazareth Gardens), provides: no access from Nazareth Gardens into "the private road", and no access from "the private road" into Consort Road, and no right turn for any vehicle proceeding in a northwest-bound direction in Consort Road at its junction with "the private road", in the London Borough of Southwark.



THE COUNCIL OF THE LONDON BOROUGH OF SOUTHWARK

# TRAFFIC MANAGEMENT ORDER

202\* No. 0\*\*

---

The London Borough of Southwark (Waiting restrictions)  
(Consort Road and Nazareth Gardens) Order 202\*

Made: 202\*

Coming into force: 202\*

---

The Council of the London Borough of Southwark, after consulting the Commissioner of Police of the Metropolis, in exercise of the powers conferred by sections 6 and 14 of and Part IV of Schedule 9 to the Road Traffic Regulation Act 1984<sup>a</sup>, as amended, and of all other powers thereunto enabling, hereby make the following Order:

## Citation, commencement and expiry

- 1.1 This Order may be cited as the London Borough of Southwark (Waiting restrictions) (Consort Road and Nazareth Gardens) Order 202\* and shall come into force on 202\*.

## Interpretation

- 2.1 In this Order:-

“Council” means the Council of the London Borough of Southwark;

“enactment” means any enactment, whether public general or local, and includes any order, bye-law, rule, regulation, scheme or other instrument having effect by virtue of an enactment;

“map-based schedule” means the map attached to and to be read in conjunction with this Order and the Order of 2021, which depicts the restrictions imposed by this Order, and, in conjunction with the map schedule legend, identifies the type of each particular waiting restriction, and, if appropriate, certain of its governing provisions:

Provided that the Council does not accept responsibility for any inaccuracies contained in the Ordnance Survey data relied upon to create the map-based schedule and where a waiting restriction is depicted on the map-based schedule, that waiting restriction will continue to apply irrespective of any subsequent changes that have been made to the underlying Ordnance Survey data.

---

<sup>a</sup> 1984 c.27

“map schedule legend” means the map schedule legend attached to this Order which, when used in conjunction with the map-based schedule, identifies the specific type of waiting restrictions imposed by this Order and, where appropriate, certain of their governing provisions; and

“the Order of 2021” means the London Borough of Southwark (Free Parking Places, Loading Places and Waiting, Loading and Stopping Restrictions) (Map-based) Order 2021<sup>b</sup>.

- 2.2 Any reference in this Order to any enactment shall be construed as a reference to that enactment as amended, applied, consolidated, re-enacted by or as having effect by virtue of any subsequent enactment.
- 2.3 Unless the context otherwise requires, any expression used in this Order which is also used in the Order of 2021 shall have the same meaning as in that Order.

#### Amendment of items in the map-based schedule

- 3.1 Without prejudice to the validity of anything done, or to any liability incurred in respect of any act or omission before the coming into force of this Order, the Order of 2021 shall have effect as though there were added to that map-based schedule the items indicating the location of waiting restrictions in Nazareth Gardens in the map-based schedule attached to this Order, and amended in that map-based schedule the items indicating the location of waiting restrictions in Consort Road in the map-based schedule attached to this Order.
- 3.2 The amendments referred to in Article 3.1 of this Order of an item in the map-based schedule will have the effect of revoking any provision provided or designated by a previous version of that item in the map-based schedule and not incorporated into the latest version.

#### Waiting restrictions applicable in restricted streets

- 4.1 Without prejudice to the validity of anything done or to any liability incurred in respect of any act or omission before the coming into operation of this Order, the Order of 2021 shall have effect as though any waiting restriction identified in the map-based schedule and by way of the map schedule legend and marked out and signed as a waiting restriction shall be construed as through it were a restricted street referred to in the Order of 2021.

Dated this xxxxxxxxxxxx day of xxxx 202\*

[signature here]

DALE FODEN

Head of Service, Highways  
Environment and Leisure

---

<sup>b</sup> LBS 2021/036



## EXPLANATORY NOTE

*(This note is not part of the Order)*

This Order, applies the provisions of, and adds items to the map-based schedule attached to the Order of 2021, make changes to waiting restrictions across junctions with 'the private road' (i) on the north-east side of Consort Road existing DYs reduced by 21.5 metres, and (ii) on the south-west side of Nazareth Gardens 16 metres of existing SYs converted to DYs, in the London Borough of Southwark.