

Public notice

Tiverton Street improvements

*The London Borough of Southwark (Loading places and Waiting restrictions) (Tiverton Street) Order 20***

1. Southwark Council hereby GIVES NOTICE that it proposes to make the above order under sections 6 and 124 of and Part IV of Schedule 9 the Road Traffic Regulation Act 1984, as amended.
2. The effects of the order would be, in TIVERTON STREET the north-west side opposite Telford House, Rockingham Estate Tiverton Street:-
 - (a) to introduce an inset loading bay (23 metres in length) in which loading only is permitted Monday to Saturday between the hours of 7 am and 7 pm (max stay 40 minutes and no return within 2 hours); and
 - (b) to remove 23 metres of timed waiting restrictions (single yellow lines) in this location to accommodate the above-mentioned loading bay.
3. For more information about these proposals please contact George Hutchful of the council's Highway Development team Highways@southwark.gov.uk .
4. Copies of this notice, the proposed order, a statement of the council's reasons for making this change and plans may be found online at www.southwark.gov.uk/trafficorders, paper copies may be obtained from or viewed at Highways, 3rd floor hub 2, 160 Tooley Street, London SE1 2QH by appointment only. Contact traffic.orders@southwark.gov.uk or 020 7525 3497 for booking details.
5. Anyone wishing to object to or make any other representations regarding the proposal, may use our consultation portal at <https://consultation.appyway.com/southwark>; or send a statement in writing to: Traffic Order Consultations, Highways, Southwark Council, Environment and Leisure, P.O. Box 64529, London SE1P 5LX or traffic.orders@southwark.gov.uk quoting reference 'TMO2122-024 Tiverton Street' by 25 November 2021. Please note that if you wish to object to this proposal you must state the grounds on which your objection is made, in writing.
6. Under requirements of current access to information legislation, any letter, form or e-mail sent to the Council in response to this Notice may be subject to publication or disclosure, or both, including communication to other persons affected.

Dated 4 November 2021

Dale Foden Head of Service - Highways, Environment and Leisure

Statement of reasons

Tiverton Street improvements

*The London Borough of Southwark (Loading places and Waiting restrictions) (Tiverton Street) Order 20***

The scheme proposes changes to accommodate a new inset loading bay in Tiverton Street (within the Chaucer ward, in the London Borough of Southwark).

The changes are implemented as part of a wider development project for 87 Newington Causeway and any associated works in the area. The loading bay is required to support the new hotel and restaurant within the redeveloped building.

In summary, the Highway proposals are to:

- (i) introduce an inset loading bay (23 metres in length) in which loading only is permitted Monday to Saturday between the hours of 7 am and 7 pm (max stay 40 minutes and no return within 2 hours); and
- (ii) remove 23 metres of timed waiting restrictions (single yellow lines) in this location to accommodate the above-mentioned loading bay.

The planning permission (ref: 16/AP/3144) granted for this development includes the provision of an inset loading bay on Tiverton Street with associated waiting restriction amendments.

Dated 4 November 2021

For more information contact:

George Hutchful
Highway Development
Highways

Highways@southwark.gov.uk

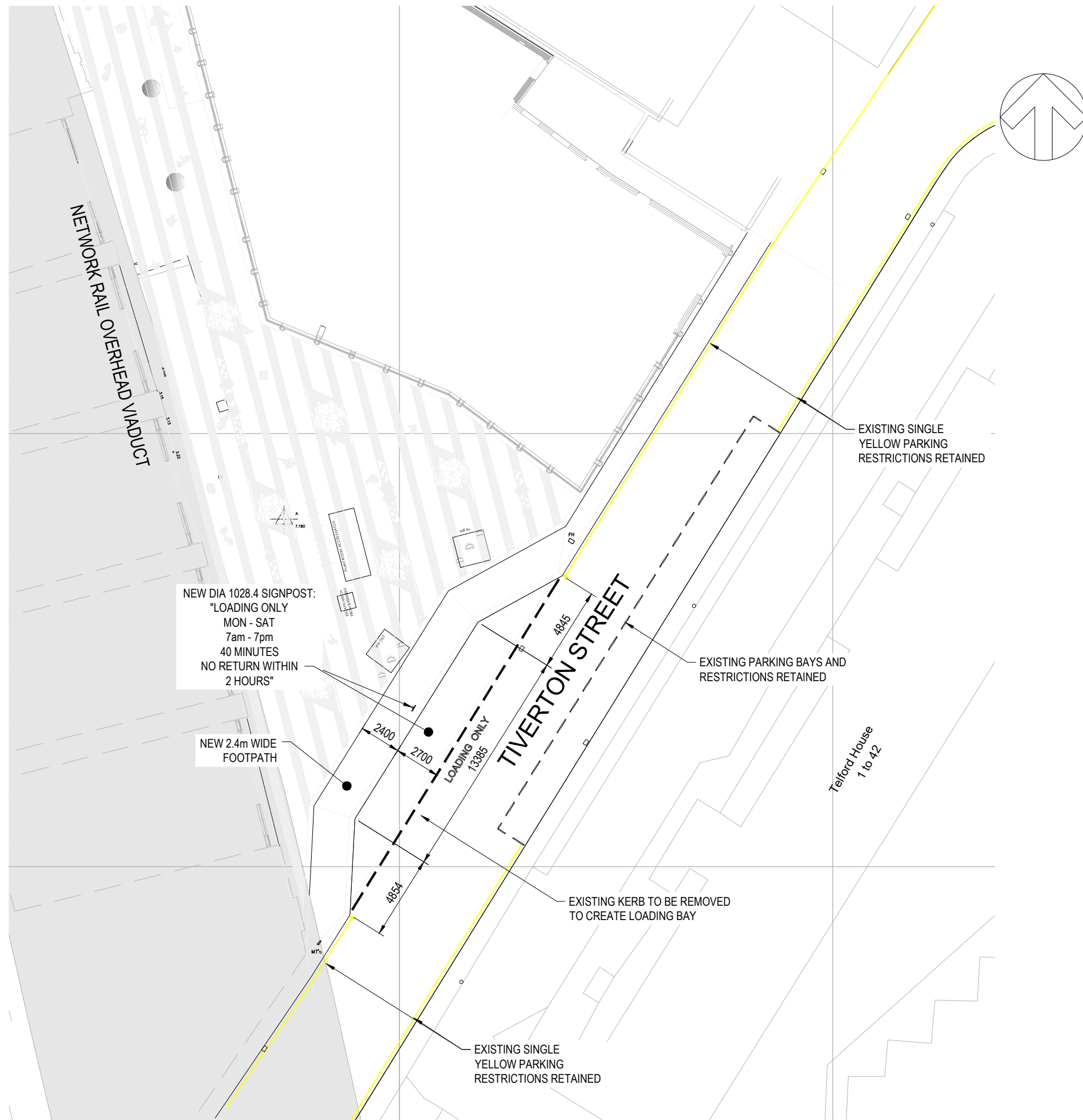

Notes :

1. ALL DRAWINGS ARE TO BE READ IN CONJUNCTION WITH ALL RELEVANT SPECIFICATIONS, BILLS OF QUANTITIES, ARCHITECTURAL, SERVICES AND ENGINEERING DRAWINGS.
2. ANY DISCREPANCIES BETWEEN THESE DOCUMENTS SHALL BE BROUGHT TO THE ATTENTION OF THE ENGINEER.
3. ALL DIMENSIONS ARE IN MILLIMETRES, UNLESS NOTED OTHERWISE.
4. ALL LEVELS ARE IN METRES RELATED TO ORDNANCE DATUM.
5. DRAWINGS ARE NOT TO BE SCALED.

| | | | | | |
|------|----------|------------------------|------|------|-----|
| P5 | 23.04.21 | Issued For Information | K.C. | TM | TM |
| P4 | 14.04.21 | Issued For Information | K.C. | TM | TM |
| P3 | 16.03.21 | Issued For Information | SEA | TM | TM |
| P2 | 22.01.21 | Issued For Information | SEA | TM | TM |
| Rev. | Date | Description | by | ch'd | app |

Project
TIVERTON STREET, SE1

Title
S278 - TRAFFIC MANAGEMENT ORDER

Client
M-S-M SURFACING

Malachy Walsh and Partners
Consulting Engineers
London | Cork | Tralee | Limerick

Suite G.02,
2 Exchange Tower,
1-2 Harbour Exchange Square
London E14 9GE, UK

Tel : +44 (0)20 72530893
fax : +44 (0)20 73367034
E-mail : drawing@mw Walsh.co.uk

ISO 9001

| | | |
|--|-------------------------|-----------------|
| DRAWN: KC | CHECKED: TM | APPROVED: TM |
| DATE: DEC 2020 | SCALE @ A1: AS SHOWN | |
| PROJECT NUMBER: 21928 | DRAWING STATUS: S2 | |
| DRAWING NUMBER: TIV-MWP-XX-ZZ-DR-C-1004 | | REV: P5 |

S278 - TRAFFIC MANAGEMENT ORDER
[SCALE 1:250]



THE COUNCIL OF THE LONDON BOROUGH OF SOUTHWARK

TRAFFIC MANAGEMENT ORDER

202* No. 0xx

The London Borough of Southwark (Loading places and Waiting restrictions)
(Tiverton Street) Order 202*

Made: xx xxx 202*

Coming into force: xx xxx 202*

The Council of the London Borough of Southwark, after consulting the Commissioner of Police of the Metropolis, in exercise of the powers conferred by sections 6 and 124 of and Part IV of Schedule 9 to the Road Traffic Regulation Act 1984^a, as amended, and of all other powers thereunto enabling, hereby make the following Order:

Citation and commencement

- 1.1 This Order may be cited as the London Borough of Southwark (Loading places and Waiting restrictions) (Tiverton Street) Order 202* and shall come into force on xx xxxx 202*.

Interpretation

- 2.1 In this Order:-

“Council” means the Council of the London Borough of Southwark;

“enactment” means any enactment, whether public general or local, and includes any order, bye-law, rule, regulation, scheme or other instrument having effect by virtue of an enactment;

“map-based schedule” means the map attached to and to be read in conjunction with this Order and the Order of 2021, which depicts the restrictions imposed by this Order and, in conjunction with the map schedule legend, identifies the type of each particular free parking place, loading place, waiting, loading or stopping restriction and, if appropriate, certain of its governing provisions:

Provided that the Council does not accept responsibility for any inaccuracies contained in the Ordnance Survey data relied upon to create the map-based schedule and where a parking place, loading place or waiting, loading or stopping restriction is depicted on the map-based schedule, that parking place, loading place or waiting, loading or stopping restriction will continue to apply irrespective of any subsequent changes that have been made to the underlying Ordnance Survey data.

“map schedule legend” means the map schedule legend attached to this Order which, when used in conjunction with the map-based schedule, identifies the specific type of parking places and loading places designated by this Order, and the waiting, loading and stopping restrictions imposed by this Order and, where appropriate, certain of their governing provisions;

^a 1984 c.27

"the Order of 2021" means the London Borough of Southwark (Free Parking Places, Loading Places and Waiting, Loading and Stopping Restrictions) (Map-based) Order 2021^b.

- 2.2 Any reference in this Order to any enactment shall be construed as a reference to that enactment as amended, applied, consolidated, re-enacted by or as having effect by virtue of any subsequent enactment.
- 2.3 Unless the context otherwise requires, any expression used in this Order which is also used in the Order of 2021 shall have the same meaning as in that Order.

Addition to or substitution of items in the map-based schedule

- 3.1 While this Order remains in force, and without prejudice to the validity of anything done, or to any liability incurred in respect of any act or omission before the coming into force of this Order, the Order of 2021 shall have effect as though:-
- (a) where there is no existing item at a location depicted in the map-based schedule attached to that Order, there were added to that map-based schedule the item depicted in the map-based schedule attached to this Order; and
 - (b) where there is an existing item at a location depicted in the map-based schedule attached to that Order, there were substituted in that map-based schedule the item depicted in the map-based schedule attached to this Order.
- 3.2 The substitution referred to in Article 3.1(b) of this Order of any item in the map-based schedule will have the effect of revoking any provision provided or designated by a previous version of that item in the map-based schedule and not incorporated into the latest version.

Designation of loading place and application of the Order of 2021 thereto

- 4.1 Each area on a street identified the map-based schedule as a loading place and, where applicable, by way of the map schedule legend as an area marked out and signed for the use therein of specified classes of vehicles following the conditions specified in the Order of 2021 in relation to that type of loading place, is designated as a loading place.
- 4.2 Unless otherwise so identified, a loading place shall be bounded on one side of its length by the edge of the carriageway and be an area marked either by a traffic sign or by another method of indicating the extent of a loading place as specified in the Traffic Signs Regulations and General Directions 2016^c.
- 4.3 The provisions of the Order of 2021 (other than Articles 4 and 15) shall apply to the area designated as a loading place by this Order as if in those provisions any reference to a loading place included a reference to an area designated as a loading place by this Order.

Placing of traffic signs etc.

- 5.1 The Council shall:-
- (a) place and maintain traffic signs or other appropriate markings on the surface of the street indicating the limits of the loading place designated by this Order;
 - (b) place and maintain in or in the vicinity of each loading place, traffic signs indicating that such loading place may be used during the permitted hours for the leaving only of the vehicles specified in Article 5.1 of the Order of 2021; and
 - (c) carry out such other work as is reasonably required for the purpose of the satisfactory operation of a loading place.

Waiting restrictions applicable in restricted streets

- 6.1 Without prejudice to the validity of anything done or to any liability incurred in respect of any act or omission before the coming into operation of this Order, the Order of 2021 shall have effect as though any waiting restriction identified in the map based schedule and by way of the map

^b LBS 2021_036

^c SI 2016/362

schedule legend and marked out and signed as a waiting restriction shall be construed as through it were a restricted street referred to in the Order of 2021.

Dated this xxxxxxxxxxxx day of xxxx 202*

[signature here]

DALE FODEN

Head of Service, Highways
Environment and Leisure

EXPLANATORY NOTE

(This note is not part of the Order)

This Order, adds or substitutes items in the map-based schedule attached to the Order of 2021, so as to introduce an inset loading place (23m in length), and remove 23m of existing SYL in Tiverton Street on the north-west side opposite Telford House – Rockingham Estate, in the London Borough of Southwark.