

# Public notice

## Dulwich Streetspace: Melbourne Grove south



*The London Borough of Southwark (Prescribed routes) (Melbourne Grove south) Traffic Order 202\**  
*The London Borough of Southwark (Waiting restrictions) (Melbourne Grove south) Order 202\**

1. Southwark Council hereby GIVES NOTICE that it proposes to make the above Orders under sections 6 and 124 of and Part IV of Schedule 9 to the Road Traffic Regulation Act 1984, as amended ('the 1984 Act').
2. The effect of the Orders would be, on a permanent basis:-
  - (a) to prohibit motor vehicles proceeding: (i) in that part of MELBOURNE GROVE which lies to the north-west of a point 3.5 metres south-east of the south-eastern kerb-line of Tell Grove from entering into that part of Melbourne Grove which lies to the south-east of that point; and (ii) in that part of MELBOURNE GROVE which lies to the south-east of a point 3.5 metres south-east of the south-eastern kerb-line of Tell Grove from entering into that part of Melbourne Grove which lies to the north-west of that point; between the hours of 8 am and 9 am and between the hours of 3 pm and 4.30 pm on Monday to Friday; and
  - (b) to provide new lengths of 'at any time' waiting restrictions (double yellow lines) in:- MELBOURNE GROVE (i) the north-east side between a point 8.5 metres north-west of the north-western kerb-line of Tell Grove and a point 15 metres south-east of the south-eastern kerb-line of Tell Grove; and (ii) on the south-west side between the common boundary of Nos. 48 and 48c Melbourne Grove and a point 17.5 metres north-west of that common boundary; and in (iii) TELL GROVE on both sides between the north-eastern kerb-line of Melbourne Grove and a point 8 metres north-east of that kerb-line.

*NOTES: (1) These Orders would supersede similar provisions at the above locations implemented by way of experimental Orders made under section 9 of the 1984 Act (which would be revoked); (2) Exemption to the restrictions described in (a) preceding would be provided for emergency services vehicles, refuse collection vehicles, taxis, and (on a discretionary basis) disabled persons vehicles (registered to Southwark resident 'blue badge' holders), rapid response healthcare workers vehicles and SEND vehicles; and (3) All measurements are in metres and are approximate.*

3. For more information contact Rachel Gates of the Council's Highways, Transport Projects team - [highways@southwark.gov.uk](mailto:highways@southwark.gov.uk) .
4. Copies of this Notice, the proposed Orders, and a statement of the Council's reasons for making the Orders together with plans showing the location and effect of the Orders may be either: found online at [www.southwark.gov.uk/trafficorders](http://www.southwark.gov.uk/trafficorders), or inspected by appointment only at: Highways, Southwark Council, Environment and Leisure, 3rd floor hub 2, 160 Tooley Street, London SE1 2QH - from the date of this Notice until the end of a period of six weeks from the date on which the Orders are made. Contact [traffic.orders@southwark.gov.uk](mailto:traffic.orders@southwark.gov.uk) (or 020 7525 3497) for booking details.
5. Anyone wishing to object to or make any other representations regarding the proposals, may use the form labelled '*Parking - Road traffic and highway schemes - responding to statutory consultation notices*' at [www.southwark.gov.uk/statutoryconsultationnotices](http://www.southwark.gov.uk/statutoryconsultationnotices) or send a statement in writing to: the Traffic Orders Officer, Highways, Southwark Council, Environment and Leisure, P.O. Box 64529, London SE1P 5LX or by e-mail to [traffic.orders@southwark.gov.uk](mailto:traffic.orders@southwark.gov.uk) quoting reference '*TMO2122-18\_DS Melbourne Grove south*' by 11 November 2021. Please note that if you wish to object to this proposal you must state the grounds on which your objection is made.
6. Under requirements of current access to information legislation, any letter or e-mail sent to the Council in response to this Notice may be subject to publication or disclosure, or both, including communication to other persons affected.

Dated 21 October 2021

**Dale Foden** - Head of Service - Highways, Environment and Leisure

# Statement of reasons

## Dulwich Streetspace: Melbourne Grove South

*The London Borough of Southwark (Prescribed routes) (Melbourne Grove south) Traffic Order 202\**

*The London Borough of Southwark (Waiting restrictions) (Melbourne Grove south) Order 202\**

The purpose to of these Orders is to implement a timed motor vehicle restriction in Melbourne Grove (south of its junction with Tell Grove) and amend waiting restrictions in Melbourne Grove and Tell Grove as permanent following review outcomes of experimental measures introduced in the East Dulwich area (Goose Green ward), in the London Borough of Southwark.

The timed restriction will operate Monday to Friday between 8-9am and 3-4.30pm to protect vulnerable road users at peak times, particularly on the journey to school and enhance the key walking and cycling route to local transport connections and high streets and will prohibit in Melbourne Grove (i) motor vehicles travelling north-westbound from entering or proceeding in that part of Melbourne Grove which lies north-west of a point 3.5 metres south-east of the south-eastern kerb-line of Tell Grove, and (ii) motor vehicles travelling south-eastbound from entering or proceeding in that part of Melbourne Grove which lies south-east of a point 3.5 metres south-east of the south-eastern kerb-line of Tell Grove.

These measures form part of the Dulwich Streetspace scheme which aims to create healthier streets which support safer active travel in the East Dulwich, Dulwich Village and Champion Hill and the timed nature of the restriction ensures that traffic is distributed more evenly across the area.

Exemption to the restrictions described in the preceding, would be provided for emergency services vehicles, refuse collection vehicles, taxis, and (on a discretionary basis) disabled persons vehicles (registered to Southwark resident 'blue badge' holders), rapid response healthcare workers vehicles and SEND vehicles.

These Orders supersede similar provisions at the above location implemented by way of experimental Order made under section 9 of the 1984 Act (which would be revoked). The trial measures were part of the London Streetspace Programme – Dulwich (public notice originally advertised in *the London Gazette* on 18 June 2020<sup>1</sup>), of which all parts of the trials will be revoked in full as parts are being proposed as new permanent changes to the Highway.

As part of the Dulwich Streetspace review an extensive public consultation was carried out for a period of 9 weeks. A good response rate was received, area-wide, and was representative of the community. The feedback received from the consultation has informed the proposals.

There will be further engagement in 2022 with the community and businesses to redesign the space to meet their needs and aspirations and a comprehensive area-wide review of all the streetspace measures.

Link to decision:

<https://moderngov.southwark.gov.uk/mglIssueHistoryHome.aspx?lId=50027352&Opt=0>

Dated 21 October 2021

For more information contact:-

**Rachel Gates**

Transport Projects

Highways

[Highways@southwark.gov.uk](mailto:Highways@southwark.gov.uk)





---

<sup>1</sup> <https://www.thegazette.co.uk/notice/3579196>

# DULWICH STREETSPACE MEASURES

MELBOURNE GROVE SOUTH

## KEY

-  Existing planters to be removed
-  Proposed sign on new post
-  Proposed sign to be mounted on existing lamp column
-  Restrictions subject to statutory consultation as a permanent traffic order

## NOTES

1. Double yellow lines to be installed where currently no restrictions are in place. Any existing on street parking to be suspended to accommodate vehicles turning.
2. Signs to be installed in locations shown to give advance warning of road closures.

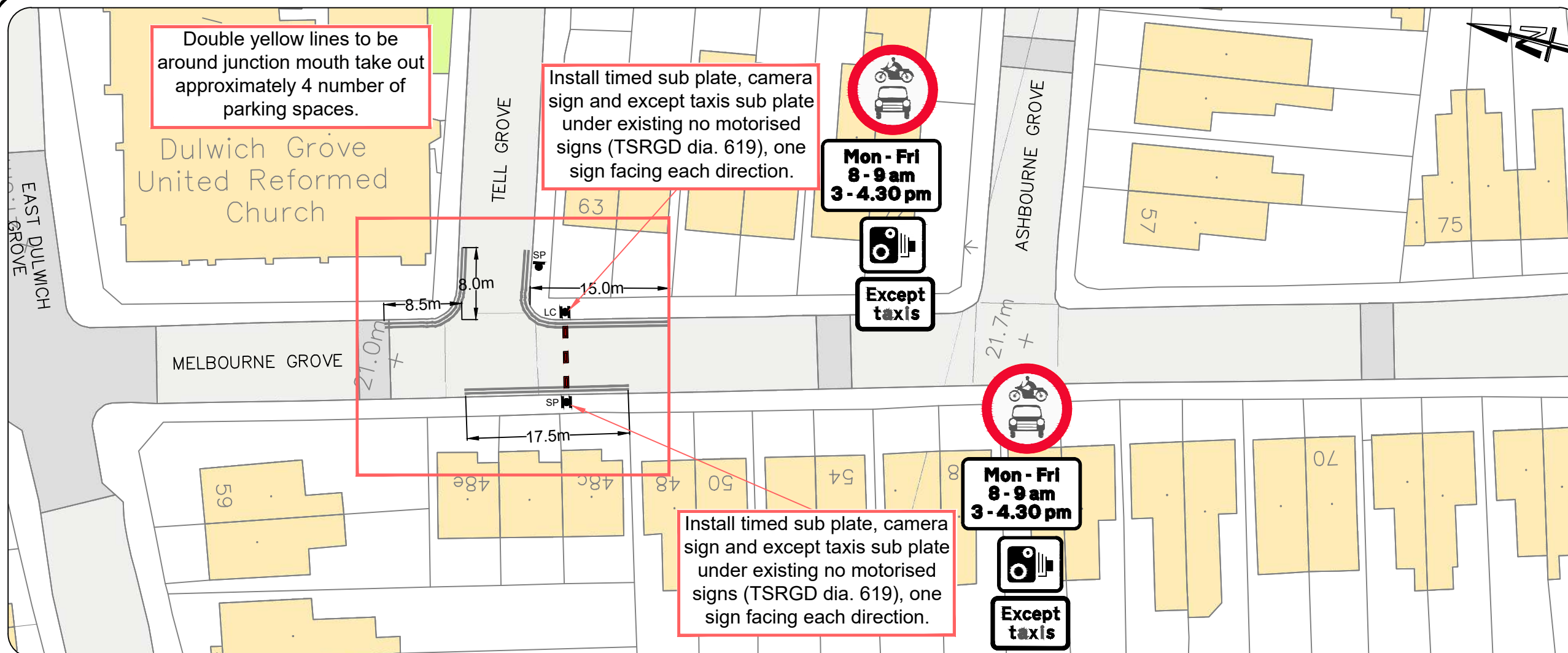



THE COUNCIL OF THE LONDON BOROUGH OF SOUTHWARK

# TRAFFIC MANAGEMENT ORDER

202\* No. \*\*\*

---

The London Borough of Southwark (Prescribed routes)  
(Melbourne Grove south) Traffic Order 202\*

Made: \*\* \*\*\*\*\* 202\*

Coming into force: \*\* \*\*\*\*\* 202\*

---

The Council of the London Borough of Southwark, after consulting the Commissioner of Police of the Metropolis, in exercise of the powers conferred by sections 6 and 124 of and Part IV of Schedule 9 to the Road Traffic Regulation Act 1984<sup>a</sup>, as amended, and of all other powers thereunto enabling, hereby make the following Order:

## Citation and commencement

- 1.1 This Order may be cited as the London Borough of Southwark (Prescribed routes) (Melbourne Grove south) Traffic Order 202\* and shall come into force on \*\* \*\*\*\*\* 202\*.

## Interpretation

- 2.1 In this Order:-

causing includes permitting;

“Council” means the Council of the London Borough of Southwark;

“disabled person’s badge” and “disabled person’s badge holder” have the same meaning as in Regulation 2 of the Disabled Persons (Badges for Motor Vehicles) (England) Regulations 2000<sup>b</sup>;

“disabled person’s vehicle” and has the same meaning as in section 142(1) of the Road Traffic Regulation Act 1984;

“enactment” means any enactment, whether public general or local, and includes any order, by-law, rule, regulation, scheme or other instrument having effect by virtue of an enactment;

“kerb-line” means the imaginary line which is the projection of the line formed by the edge of the carriageway of a street;

“motor vehicle” has the same meaning as in section 136 of the Road Traffic Regulation Act 1984;

“prescribed hours” means the (inclusive) periods between 8 am and 9 am, and between 3 pm and 4.30 pm on Monday to Friday;

---

<sup>a</sup> 1984 c.27

<sup>b</sup> SI 2000/682

“prescribed street” for the purposes of Article 5.1(c) of this Order means a street or part thereof referred to in either Articles 4.1 or 4.2 of this Order; and

“taxi” has the same meaning as in Schedule 1 to the Traffic Signs Regulations and General Directions 2016<sup>c</sup>.

- 2.2 Any reference in this Order to any enactment shall be construed as a reference to that enactment as amended, applied, consolidated, re-enacted by or as having effect by virtue of any subsequent enactment.

### Revocation

- 3.1 Without prejudice to anything done or any liability incurred in respect of any act or omission before the coming into force of this Order, the London Borough of Southwark (Prescribed routes) (Melbourne Grove) Experimental Traffic Order 2020<sup>d</sup> is hereby revoked.

### Prescribed routes

- 4.1 No person causing any motor vehicle to proceed in a south-eastbound direction in that part of Melbourne Grove which lies to the north-west of a point 3.5 metres south-east of the south-eastern kerb-line of Tell Grove shall, upon reaching that point, cause that motor vehicle to enter into that part of Melbourne Grove which lies to the south-east of a point 3.5 metres south-east of the south-eastern kerb-line of Tell Grove, during the prescribed hours.
- 4.2 No person causing any motor vehicle to proceed in a north-westbound direction in that part of Melbourne Grove which lies to the south-east of a point 3.5 metres south-east of the south-eastern kerb-line of Tell Grove shall, upon reaching that point, cause that motor vehicle to enter into that part of Melbourne Grove which lies to the north-west of a point 3.5 metres south-east of the south-eastern kerb-line of Tell Grove, during the prescribed hours.

### Exemptions

- 5.1 Nothing in Articles 4.1 and 4.2 of this Order shall apply in relation to:-
- (a) anything done with the permission or at the direction of a police constable in uniform;
  - (b) any vehicle being used for ambulance, fire brigade or police purposes;
  - (c) a refuse collection vehicle being operated by the Council or its appointed contractor, whilst being used for the purpose of refuse collection at premises located within a prescribed street;
  - (d) any vehicle being used for the purpose of maintenance, improvement, re-construction, cleansing or lighting of that part of street;
  - (e) any vehicle being used in connection with the laying, erection, alteration, or repair in or adjacent to that part of street of any sewer, main, pipe or apparatus for the supply of gas, water, electricity, or of any electronic communications network; or the placing, maintenance or removal of any traffic sign, if the vehicle cannot be used for that purpose in any other street or part of street;
  - (f) any person who causes any vehicle to proceed in accordance with any restriction or requirement indicated by traffic signs placed on the highway pursuant to section 66 or section 67 of the Road Traffic Regulation Act 1984;
  - (g) a taxi;
  - (h) a disabled person’s vehicle, the vehicle registration number thereof being registered with and authorised by the Council for this purpose by or on the behalf of a disabled person’s badge holder resident in the London Borough of Southwark, such authorisation being granted by the Council on a discretionary basis and subject to such criteria as may be set from time to time by the Council;

---

<sup>c</sup> SI 2016/362

<sup>d</sup> LBS 2020/054

- (i) a vehicle recognised by the Council as a being a “rapid response healthcare workers vehicle”, the vehicle registration number thereof being registered with and authorised by the Council for this purpose by or on the behalf of a healthcare worker or healthcare organisation providing healthcare services to residents of the London Borough of Southwark, such authorisation being granted by the Council on a discretionary basis and subject to such criteria as may be set from time to time by the Council; or
- (j) a vehicle recognised by the Council as being a “SEND vehicle”, the vehicle registration number thereof being registered with and authorised by the Council for this purpose by or on the behalf of a person or organisation providing “SEND” services in the London Borough of Southwark, such authorisation being granted by the Council on a discretionary basis and subject to such criteria as may be set from time to time by the Council.

Dated this \*\*\*\*\* day of \*\*\*\*\* 202\*

[signature here]

DALE FODEN  
Head of Service, Highways  
Environment and Leisure

## EXPLANATORY NOTE

*(This note is not part of the Order)*

This Order, on a permanent basis, provides a point 'no motor vehicles' restriction, applicable to both south-eastbound and north-westbound vehicles, which will operate between the hours of 8 am and 9 am and between 3 pm and 4.30 pm on Monday to Friday, in Melbourne Grove, south-east of its junction with Tell Grove with certain exemptions, in the London Borough of Southwark.



THE COUNCIL OF THE LONDON BOROUGH OF SOUTHWARK

# TRAFFIC MANAGEMENT ORDER

202\* No. 0\*\*

---

The London Borough of Southwark (Waiting restrictions) (Melbourne Grove south) Order 202\*

Made: 202\*

Coming into force: 202\*

---

The Council of the London Borough of Southwark, after consulting the Commissioner of Police of the Metropolis, in exercise of the powers conferred by sections 6 and 14 of and Part IV of Schedule 9 to the Road Traffic Regulation Act 1984<sup>a</sup>, as amended, and of all other powers thereunto enabling, hereby make the following Order:

## Citation, commencement and expiry

- 1.1 This Order may be cited as the London Borough of Southwark (Waiting restrictions) (Melbourne Grove south) Order 202\* and shall come into force on 202\*.

## Interpretation

- 2.1 In this Order:-

“Council” means the Council of the London Borough of Southwark;

“enactment” means any enactment, whether public general or local, and includes any order, bye-law, rule, regulation, scheme or other instrument having effect by virtue of an enactment;

“map-based schedule” means the map attached to and to be read in conjunction with this Order and the Order of 2021, which depicts the restrictions imposed by this Order, and, in conjunction with the map schedule legend, identifies the type of each particular waiting restriction, and, if appropriate, certain of its governing provisions:

Provided that the Council does not accept responsibility for any inaccuracies contained in the Ordnance Survey data relied upon to create the map-based schedule and where a waiting restriction is depicted on the map-based schedule, that waiting restriction will continue to apply irrespective of any subsequent changes that have been made to the underlying Ordnance Survey data.

---

<sup>a</sup> 1984 c.27



"map schedule legend" means the map schedule legend attached to this Order which, when used in conjunction with the map-based schedule, identifies the specific type of waiting restrictions imposed by this Order and, where appropriate, certain of their governing provisions; and

"the Order of 2021" means the London Borough of Southwark (Free Parking Places, Loading Places and Waiting, Loading and Stopping Restrictions) (Map-based) Order 2021<sup>b</sup>.

- 2.2 Any reference in this Order to any enactment shall be construed as a reference to that enactment as amended, applied, consolidated, re-enacted by or as having effect by virtue of any subsequent enactment.
- 2.3 Unless the context otherwise requires, any expression used in this Order which is also used in the Order of 2021 shall have the same meaning as in that Order.

#### Amendment of items in the map-based schedule

- 3.1 Without prejudice to the validity of anything done, or to any liability incurred in respect of any act or omission before the coming into force of this Order, the Order of 2021 shall have effect as though there were added to that map-based schedule the items indicating the location of waiting restrictions in Melbourne Grove and Tell Grove in the map-based schedule attached to this Order.
- 3.2 The amendments referred to in Article 3.1 of this Order of an item in the map-based schedule will have the effect of revoking any provision provided or designated by a previous version of that item in the map-based schedule and not incorporated into the latest version.

#### Waiting restrictions applicable in restricted streets

- 4.1 Without prejudice to the validity of anything done or to any liability incurred in respect of any act or omission before the coming into operation of this Order, the Order of 2021 shall have effect as though any waiting restriction identified in the map-based schedule and by way of the map schedule legend and marked out and signed as a waiting restriction shall be construed as through it were a restricted street referred to in the Order of 2021.

Dated this \*\*\*\*\* day of \*\*\*\*\* 202\*

[signature here]

DALE FODEN  
Head of Service, Highways  
Environment and Leisure

---

<sup>b</sup> LBS 2021/036

## EXPLANATORY NOTE

*(This note is not part of the Order)*

This Order, applies the provisions of, and adds items to the map-based schedule attached to the Order of 2021, as part of Dulwich Streetspace so as to permanently provide new or extended lengths of 'at any time' waiting restrictions in Melbourne Grove and Tell Grove, complementary to the timed closure of Melbourne Grove to motor vehicles south of its junction with Tell Grove, in the London Borough of Southwark.