

### LEGEND

- Proposed asphalt footway construction. Refer to series 1100.
- Proposed stepped cycle track construction. Refer to series 1100.
- Proposed asphalt raised table construction. Refer to series 1100.
- Proposed low level landscaping area. Refer to series 1100.
- Proposed carriageway resurfacing. Refer to series 1100.
- Proposed kerbs. Refer to series 1100.
- Proposed footway channel. Refer to series 1100.
- Proposed granite quadrant kerbs. Refer to series 1100.
- Proposed uncontrolled blister tactile paving construction. Refer to series 1100.
- Proposed TMP Heritage bollard to be installed. Refer to series 1100.
- Proposed Wands to be installed. Refer to series 1100.
- Existing gully to remain. Refer to series 500.
- Proposed gully to be installed. Refer to series 500.
- Proposed chute gully to be installed. Refer to series 500.
- Existing gully affected by changing levels. Refer to series 500.
- Existing lighting column to remain.
- Proposed cycle stand to be installed. Refer to series 1100.
- Utility covers and frames to be adjusted to match new carriageway/footway levels. Refer to setting out and levels drawings.
- New road markings. Refer to series 1200.
- Existing road markings to remain. Refer to series 1200.
- Proposed road sign on existing signpost. Refer to series 1200.
- Proposed road sign on existing lamp column. Refer to series 1200.
- Proposed sign on new post. Refer to series 1200.
- Proposed Belisha beacons. Refer to series 1100.
- Proposed bench. Refer to series 1100.
- Proposed tree. Species to be confirmed by Southwark Arboricultural Officer.

- ### NOTES:
1. All dimensions are in metres unless otherwise stated. Do not scale from this drawing.
  2. All items shown in grey are existing and are to remain unless stated otherwise.
  3. The information shown on this drawing is based on a topographical survey undertaken by 'Premier Surveys' in November 2017 and June 2018.
  4. This drawing is to be read in conjunction with all CONWAY AECOM drawings for job ref. 60493383-C0472 as listed on the scheme drawing contents table.
  5. This drawing is to be read in conjunction with LB Southwark Streetscape Design Manual (SSDM) and all relevant contract clauses.
  6. Traffic management is to be in accordance with Chapter 8 of the Traffic Signs Manual and Safety at Street Works and Road Works.
  7. Contractor to scan for services prior to excavation and refer to utility records.
  8. Contractor to maintain access to all properties and businesses at all times and agree alternative access arrangements with stakeholders.
  9. Tactile paving to be laid with a maximum gradient of 1:12.
  10. Damaged slabs, blocks or kerbs as part of the adjacent construction works to be reinstated to match existing.

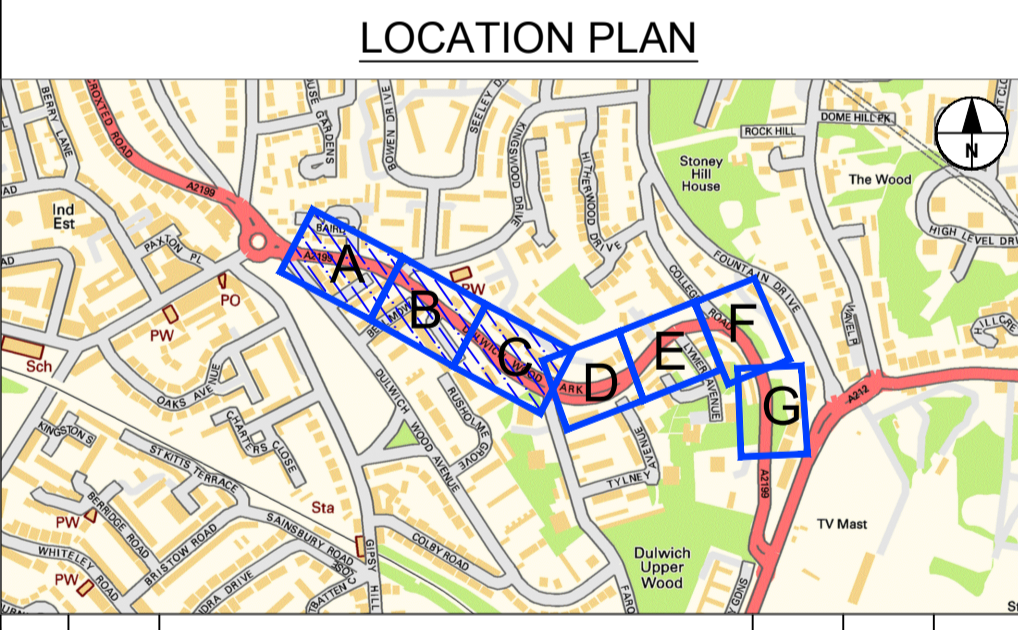

REV	DATE	REVISION DESCRIPTION / DETAILS	DRN BY	CHKD BY	APRVD BY
B	29/03/19	FINAL DETAILED DESIGN PACKAGE	SA	SIA	AGB
A	18/12/18	REVISION FOLLOWING DQW	SA	RJB	AGB
0	16/11/18	FIRST ISSUE	SA	AMC	YD

Shaping Southwark's Highways  
160 TOOLEY STREET LONDON SE1P 5LX

PROJECT:		20mph Traffic Calming Review DETAILED DESIGN	
TITLE:		DULWICH WOOD PARK SERIES 100 GENERAL ARRANGEMENT SHEET 1 OF 3	
CONTRACT NO:	60493383-C0472	DRAWN:	SA
SCALE:	1 : 200 @ A1	PURPOSE:	FOR CONSTRUCTION
DRAWING NO:	60493383-C0472-100-01	CHECKED:	SIA
DATE DRAWN:	SEPTEMBER 2018	APPROVED:	AGB
DATE ISSUED:	29 MARCH 2019	REV:	B



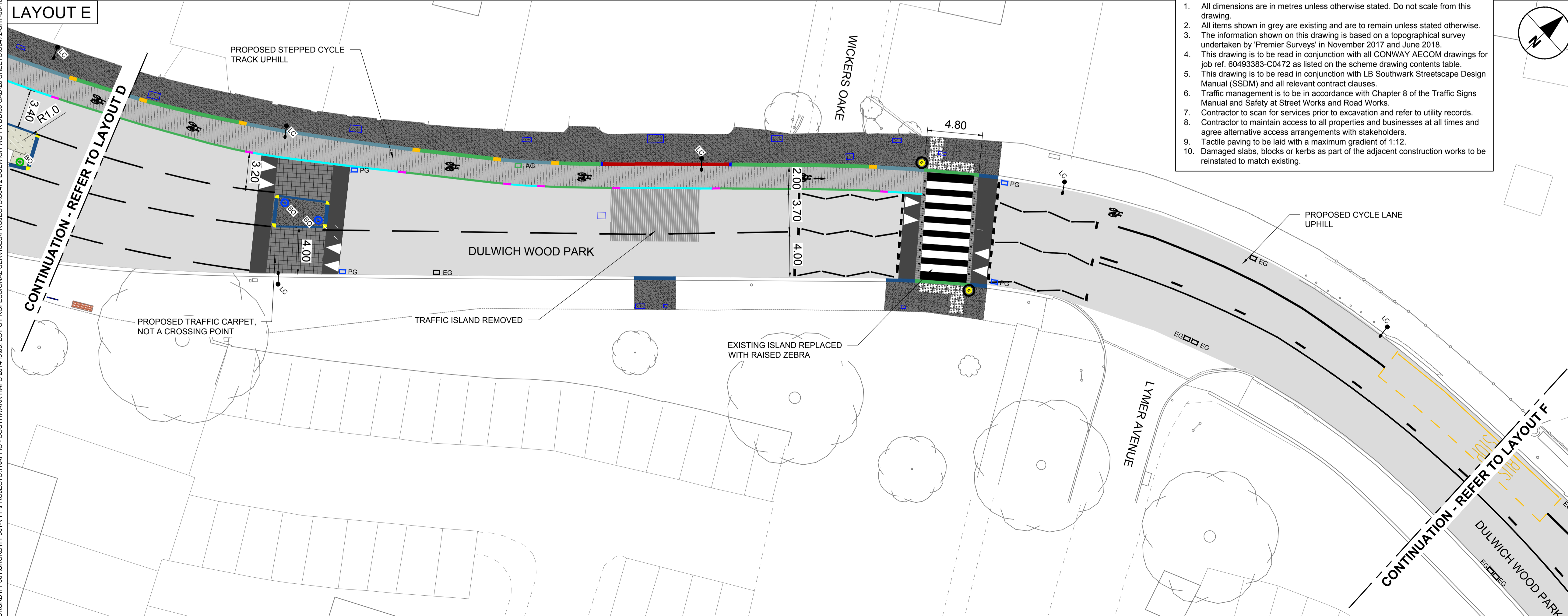
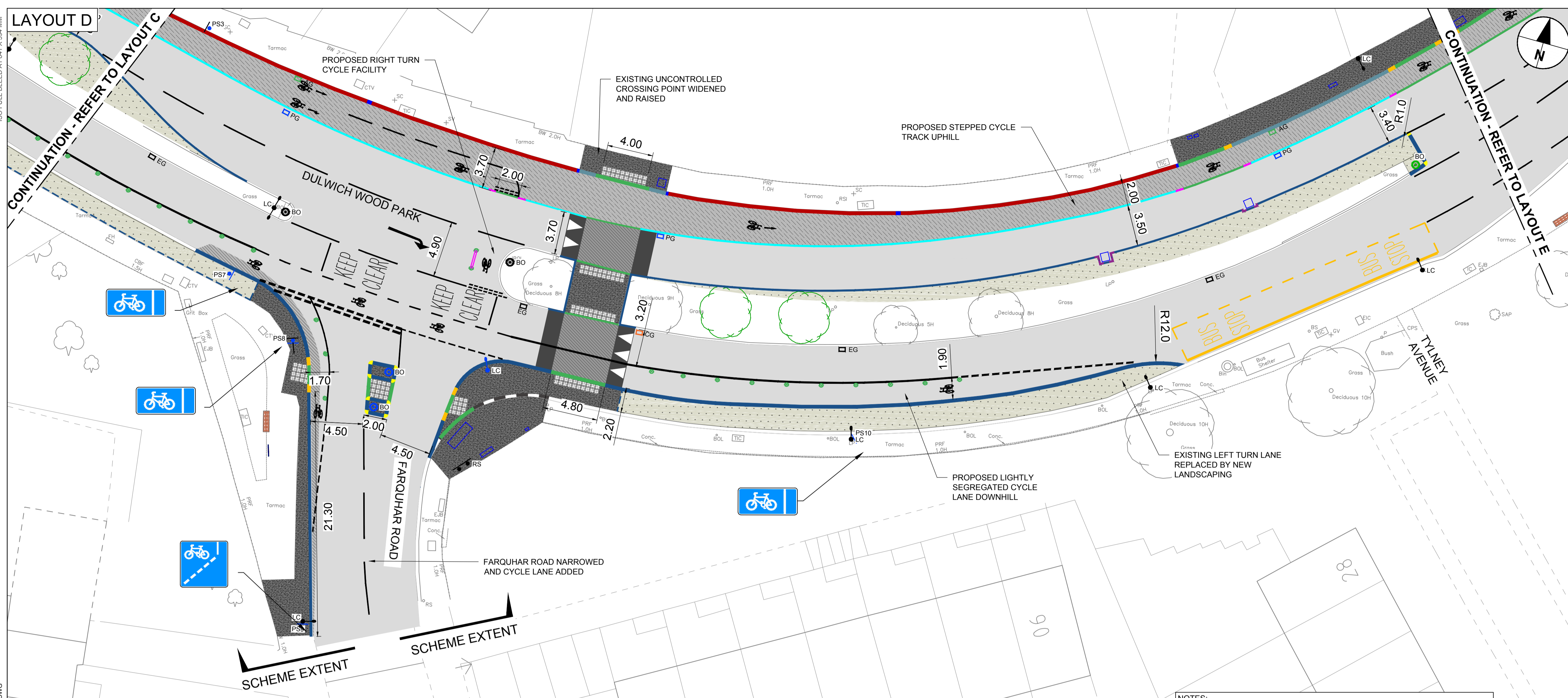

KEY		LEGEND	
[Pattern]	Proposed asphalt footway construction. Refer to series 1100.	[Pattern]	Proposed asphalt raised table construction. Refer to series 1100.
[Pattern]	Proposed stepped cycle track construction. Refer to series 1100.	[Pattern]	Proposed low level landscaped area. Refer to series 1100.
[Pattern]	Proposed carriageway resurfacing. Refer to series 1100.	[Pattern]	Proposed full carriageway construction. Refer to series 1100.
[Pattern]	Proposed traffic carpet construction. Refer to series 1100.	[Pattern]	Proposed kerbs. Refer to series 1100.
[Pattern]	Existing kerb retained to form footway channel. Refer to series 1100.	[Symbol]	Proposed granite quadrant kerbs. Refer to series 1100.
[Symbol]	Proposed 90 degree angle kerbs. Refer to series 1100.	[Symbol]	Uncontrolled blister tactile paving construction. Refer to series 1100.
[Symbol]	Proposed TMP Heritage bollard to be installed. Refer to series 1100.	[Symbol]	Proposed Wands to be installed. Refer to series 1100.
[Symbol]	Proposed Wands to be installed. Refer to series 1100.	[Symbol]	Existing gully to remain. Refer to series 500.
[Symbol]	Existing gully to remain. Refer to series 500.	[Symbol]	Proposed gully to be installed. Refer to series 500.
[Symbol]	Proposed gully to be installed. Refer to series 500.	[Symbol]	Proposed chute gully to be installed. Refer to series 500.
[Symbol]	Proposed chute gully to be installed. Refer to series 500.	[Symbol]	Existing gully affected by changing levels. Refer to series 500.
[Symbol]	Existing gully affected by changing levels. Refer to series 500.	[Symbol]	Existing lighting column to remain.
[Symbol]	Existing lighting column to remain.	[Symbol]	Proposed cycle stand to be installed. Refer to series 1100.
[Symbol]	Proposed cycle stand to be installed. Refer to series 1100.	[Symbol]	Utility covers and frames to be adjusted to match new carriageway/footway levels. Refer to setting out and levels drawings.
[Symbol]	Utility covers and frames to be adjusted to match new carriageway/footway levels. Refer to setting out and levels drawings.	[Symbol]	New road markings. Refer to series 1200.
[Symbol]	New road markings. Refer to series 1200.	[Symbol]	Existing road markings to remain. Refer to series 1200.
[Symbol]	Existing road markings to remain. Refer to series 1200.	[Symbol]	Proposed road sign on existing signpost. Refer to series 1200.
[Symbol]	Proposed road sign on existing signpost. Refer to series 1200.	[Symbol]	Proposed road sign on existing lamp column. Refer to series 1200.
[Symbol]	Proposed road sign on existing lamp column. Refer to series 1200.	[Symbol]	Proposed sign on new post. Refer to series 1200.
[Symbol]	Proposed sign on new post. Refer to series 1200.	[Symbol]	Proposed Belisha beacons. Refer to series 1100.
[Symbol]	Proposed Belisha beacons. Refer to series 1100.	[Symbol]	Proposed bench. Refer to series 1100.
[Symbol]	Proposed bench. Refer to series 1100.	[Symbol]	Proposed tree. Species to be confirmed by Southwark Arboricultural Officer.
[Symbol]	Proposed tree. Species to be confirmed by Southwark Arboricultural Officer.	[Symbol]	Proposed Wands Orca unit. Refer to series 1100.
[Symbol]	Proposed Wands Orca unit. Refer to series 1100.		

- NOTES:**
- All dimensions are in metres unless otherwise stated. Do not scale from this drawing.
  - All items shown in grey are existing and are to remain unless stated otherwise.
  - The information shown on this drawing is based on a topographical survey undertaken by 'Premier Surveys' in November 2017 and June 2018.
  - This drawing is to be read in conjunction with all CONWAY AECOM drawings for job ref. 60493383-C0472 as listed on the scheme drawing contents table.
  - This drawing is to be read in conjunction with LB Southwark Streetscape Design Manual (SSDM) and all relevant contract clauses.
  - Traffic management is to be in accordance with Chapter 8 of the Traffic Signs Manual and Safety at Street Works and Road Works.
  - Contractor to scan for services prior to excavation and refer to utility records.
  - Contractor to maintain access to all properties and businesses at all times and agree alternative access arrangements with stakeholders.
  - Tactile paving to be laid with a maximum gradient of 1:12.
  - Damaged slabs, blocks or kerbs as part of the adjacent construction works to be reinstated to match existing.

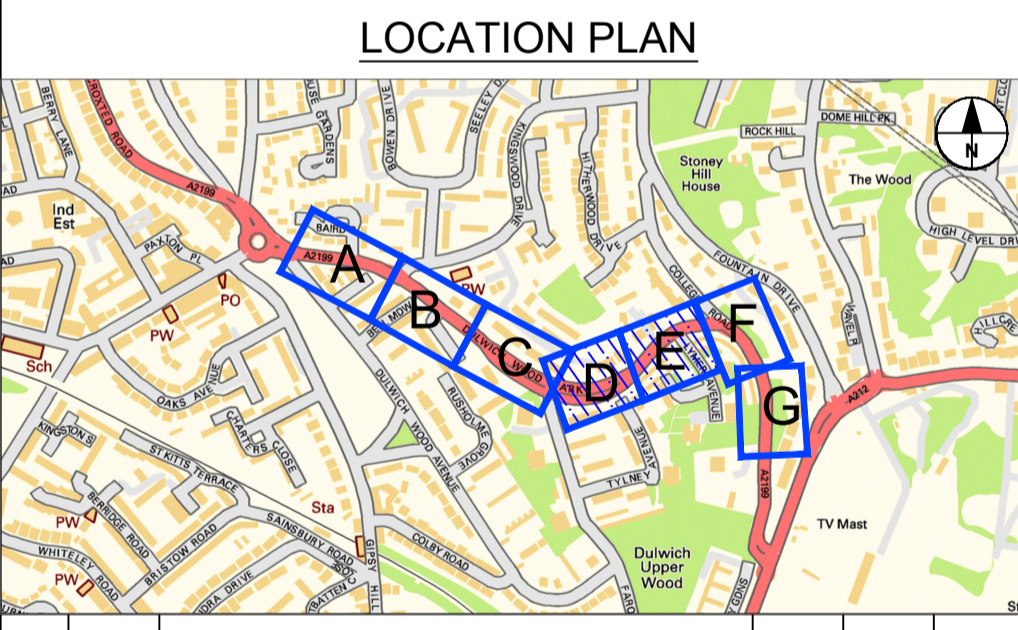

REV	DATE	REVISION DESCRIPTION / DETAILS	DRN BY	CHKD BY	APRVD BY
B	29/03/19	FINAL DETAILED DESIGN PACKAGE	SA	SIA	AGB
A	18/12/18	REVISION FOLLOWING DQW	SA	RJB	AGB
0	16/11/18	FIRST ISSUE	SA	AMC	YD



PROJECT:		20mph Traffic Calming Review DETAILED DESIGN	
TITLE:		DULWICH WOOD PARK SERIES 100 GENERAL ARRANGEMENT SHEET 2 OF 3	
CONTRACT NO:	60493383-C0472	DRAWN:	SA
SCALE:	1 : 200 @ A1	PURPOSE:	FOR CONSTRUCTION
DRAWING NO:	60493383-C0472-100-02	CHECKED:	SIA
DATE DRAWN:	SEPTEMBER 2018	APPROVED:	AGB
DATE ISSUED:	29 MARCH 2019	REV:	B



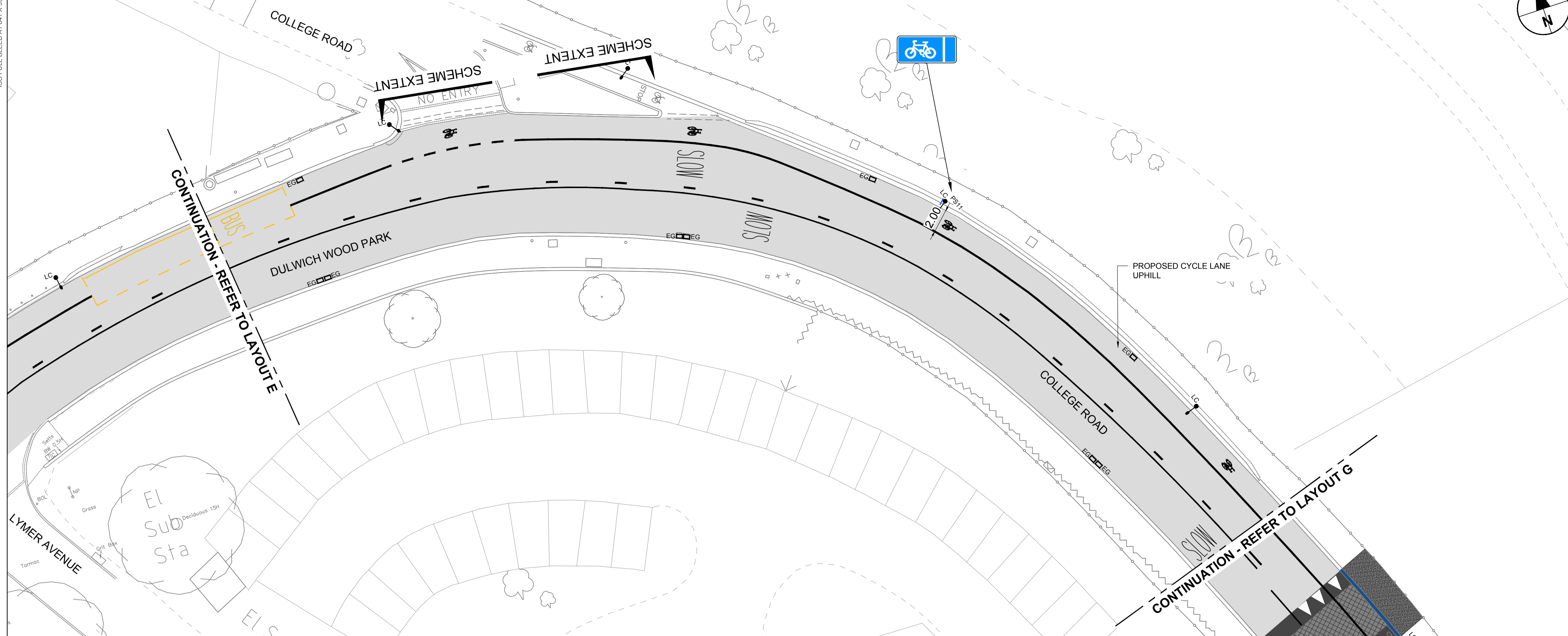

### LEGEND

**KEY**

- Proposed carriageway resurfacing. Refer to series 1100.
- Proposed asphalt traffic carpet construction. Refer to series 1100.
- New road markings. Refer to series 1200.
- Existing road markings to remain. Refer to series 1200.
- Existing lighting column to remain.
- Existing gully to remain. Refer to series 500.
- Proposed gully to be installed. Refer to series 500.
- Proposed road sign on existing post. Refer to series 1200.

- ### NOTES
- All dimensions are in metres unless otherwise stated. Do not scale from this drawing.
  - All items shown in grey are existing and are to remain unless stated otherwise.
  - The information shown on this drawing is based on a topographical survey undertaken by 'Premier Surveys' in November 2017 and June 2018.
  - This drawing is to be read in conjunction with all CONWAY AECOM drawings for job ref. 60493383-C0472 as listed on the scheme drawing contents table.
  - This drawing is to be read in conjunction with LB Southwark Streetscape Design Manual (SSDM) and all relevant contract clauses.
  - Traffic management is to be in accordance with Chapter 8 of the Traffic Signs Manual and Safety at Street Works and Road Works.
  - Contractor to scan for services prior to excavation and refer to utility records.
  - Contractor to maintain access to all properties and businesses at all times and agree alternative access arrangements with stakeholders.
  - Tactile paving to be laid with a maximum gradient of 1:12.
  - Damaged slabs, blocks or kerbs as part of the adjacent construction works to be reinstated to match existing.

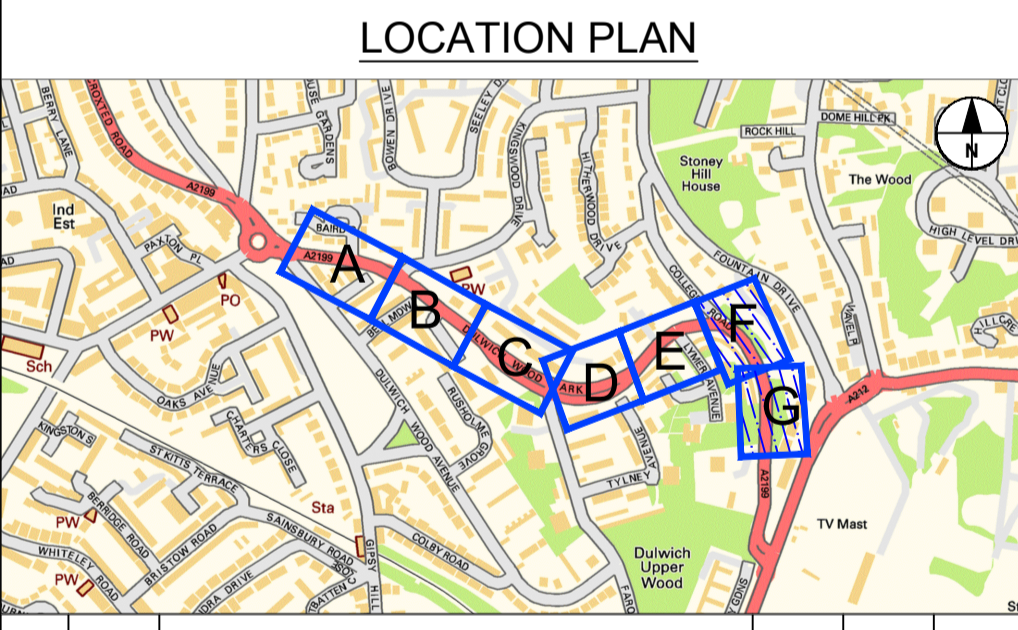

REV	DATE	REVISION DESCRIPTION / DETAILS	DRN BY	CHKD BY	APRVD BY
B	29/03/19	FINAL DETAILED DESIGN PACKAGE	SA	SIA	AGB
A	18/12/18	REVISION FOLLOWING DQW	SA	RJB	AGB
0	16/11/18	FIRST ISSUE	SA	AMC	YD

Shaping Southwark's Highways  
160 TOOLEY STREET LONDON SE1P 5LX

PROJECT:		20mph Traffic Calming Review DETAILED DESIGN	
TITLE:		DULWICH WOOD PARK SERIES 100 GENERAL ARRANGEMENT SHEET 3 OF 3	
CONTRACT NO:	60493383-C0472	DRAWN:	SA
SCALE:	1 : 200 @ A1	DESIGNED:	SA
DRAWING NO:	60493383-C0472-100-03	CHECKED:	SIA
DATE DRAWN:	SEPTEMBER 2018	APPROVED:	AGB
DATE ISSUED:	29 MARCH 2019	REV:	B