

### 8th to 13th Floor

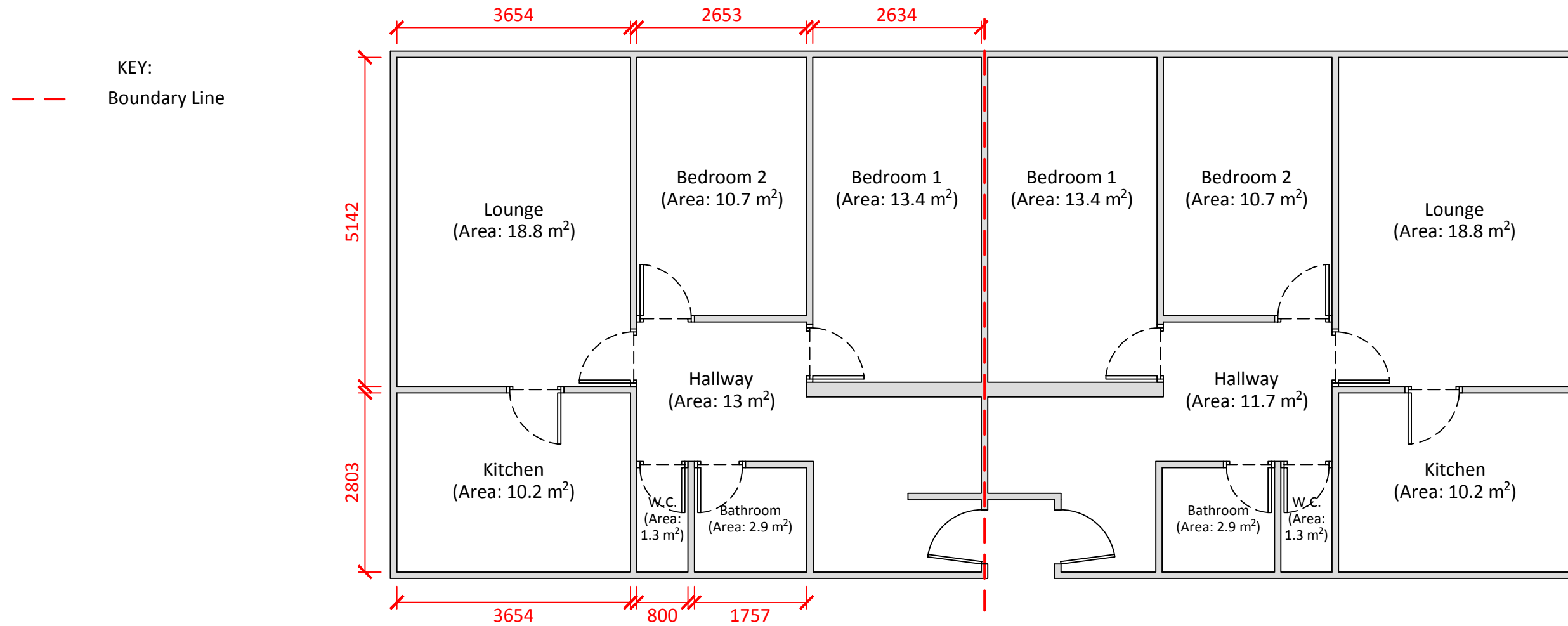

KEY:  
--- Boundary Line

Two Bedroom Flat:  
(Area: 70 m<sup>2</sup>)

Two Bedroom Flat:  
(Area: 70 m<sup>2</sup>)



Client  
London Borough of Southwark Council  
Project  
Ledbury Refurbishment Project  
Title  
Bromyard House Indicative Existing Floor Plan

Scale: NTS      Date: 28/11/19      Drawn By: DyS      Checked By: CH      Project No: K180809      Drawing No: BS002      Revision:

St Johns House 1A Knoll Rise Orpington Kent BR6 0JX  
01689 888222 orpington@calfordseaden.com  
calfordseaden LLP is a Limited Liability Partnership Registered in England & Wales number OC315838

ORPINGTON | LONDON | BIRMINGHAM | CAMBRIDGE | SOUTHEND-ON-SEA | WINCHESTER

calfordseaden.com

REV	DESCRIPTION	DATE	INIT	CHKD