

8th to 13th Floor

- KEY:
- Boundary Line
 - ┌ Steel Hanger
 - Sheer Wall & Jacket
 - New Floor Area

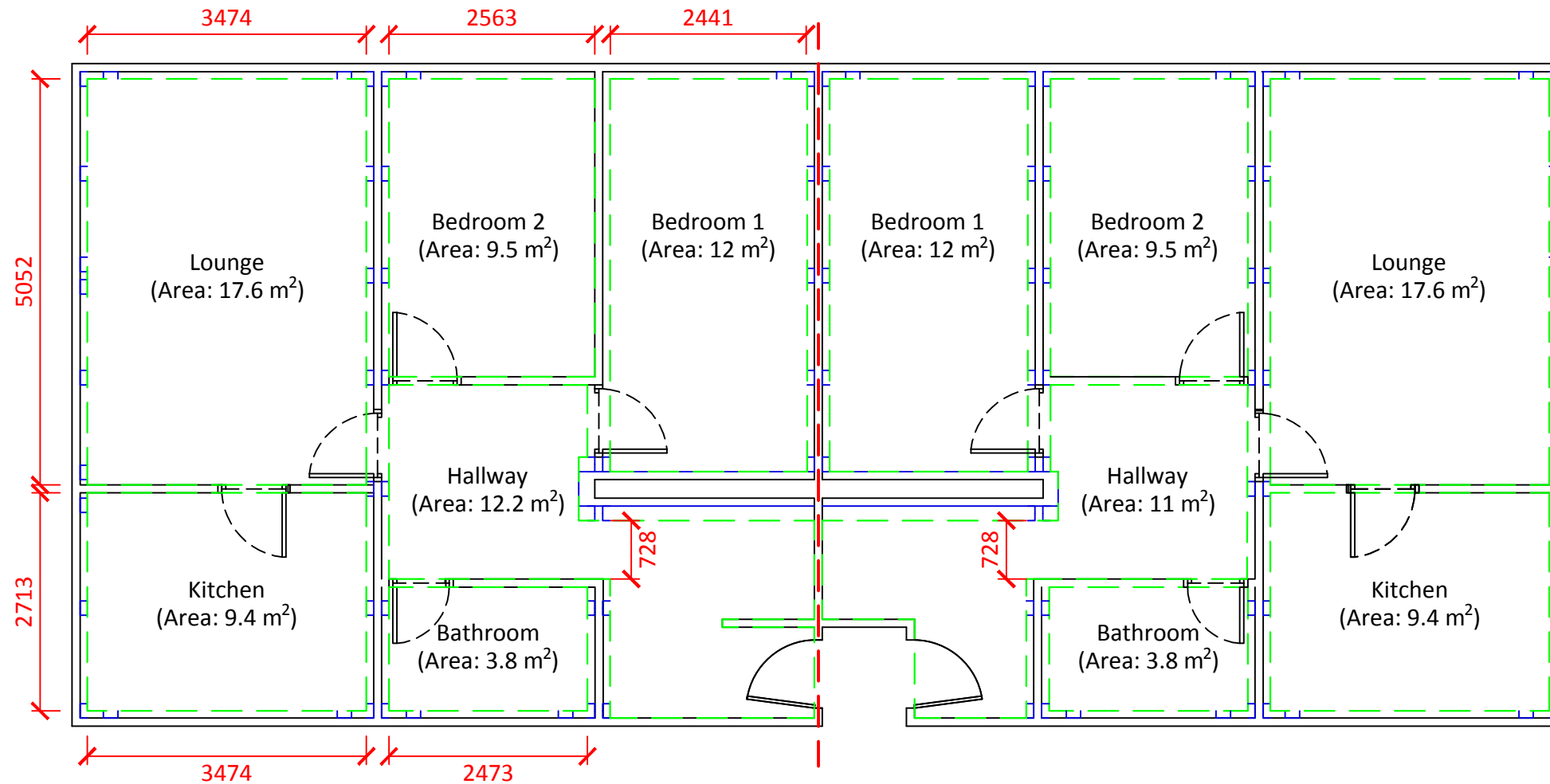

Two Bedroom Flat:
(Area: 64 m²)

Two Bedroom Flat:
(Area: 64 m²)



Client
London Borough of Southwark Council
Project
Ledbury Refurbishment Project
Title
Bromyard House Indicative Proposed Floor Plan

Scale NTS	Date 28/11/19	Drawn By DyS	Checked By CH	Project No: K180809	Drawing No: BS006	Revision
--------------	------------------	-----------------	------------------	------------------------	----------------------	----------

St Johns House 1A Knoll Rise Orpington Kent BR6 0JX
01689 888222 orpington@calfordseaden.com
calfordseaden LLP is a Limited Liability Partnership Registered in England & Wales number OC315838

ORPINGTON | LONDON | BIRMINGHAM | CAMBRIDGE | SOUTHEND-ON-SEA | WINCHESTER

calfordseaden.com

REV	DESCRIPTION	DATE	INIT	CHKD